

1434ZDF | 声波振动电机 Sonic Motor

应用领域：电动牙刷、保健器材、清洁用具等。

Applications: electric toothbrushes, health care products, cleaning equipment, etc.

主要技术指标 | Characteristics

				-1-L1-3.7
1	电压	Voltage	V	3.7
2	直流电阻	Resistance	Ω	3.8
3	工作频率范围	Operating frequency range	Hz	220~360
4	空载振动频次	No-load vibration frequency	Times / minute	39600
5	空载振动电流	No-load current	mA	90
6	启动转矩	Starting torque	mNm	12
7	启动电流	Starting current	A	1.0
8	负载 (刷头)	Rated load (Brush head)	g	3.8
9	负载振动频次	Load vibration frequency	Times / minute	31200
10	负载电流	Load current	mA	400
11	转子惯量	Rotor inertia	gcm^2	0.9
12	重量	Weight	g	25
13	工作温度范围	Operating temperature range	$^{\circ}\text{C}$	-10~+60

★可选参数 Options: 导线长度 Lead wires length 轴长 Shaft length 性能 Special coils

特性曲线 | Characteristics Curve

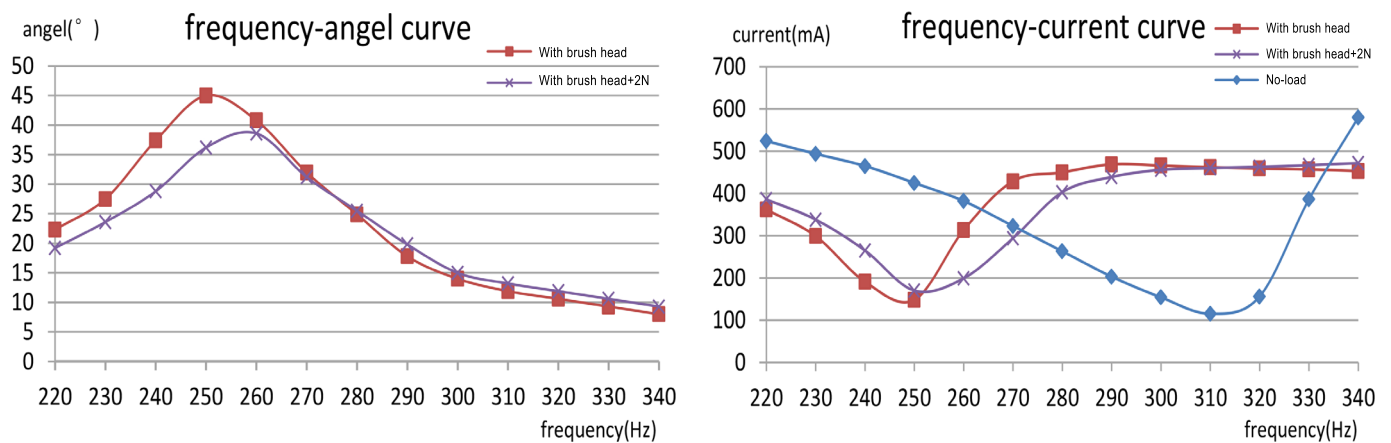

型号 / Model 1434ZDF-1-L1-3.7

外观图 | Outline Drawing

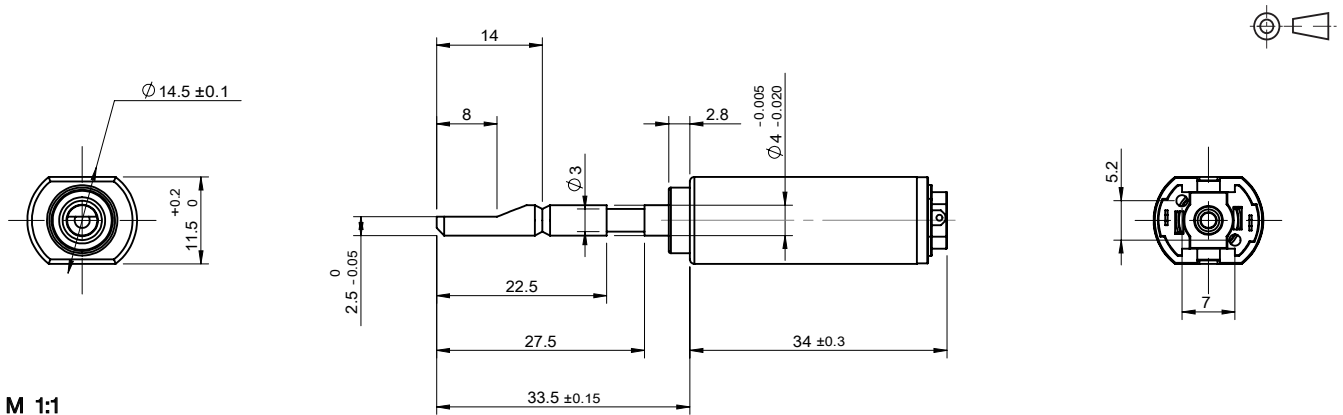

M 1:1