

## 1941ZDF | 声波振动电机 Sonic Motor

应用领域：电动牙刷、保健器材、清洁用具等。

Applications: electric toothbrushes, health care products, cleaning equipment, etc.

### 主要技术指标 | Characteristics

			-1-L3-2.5	-1-L2-30-3.7	-1K-L4-30-3.7
1	电压	Voltage	V	3.7	3.7
2	直流电阻	Resistance	$\Omega$	3.5	3.7
3	工作频率范围	Operating frequency range	Hz	200~360	200~360
4	空载振动频次	No-load vibration frequency	Times / minute	38400	38400
5	空载振动电流	No-load current	mA	80	90
6	启动转矩	Starting torque	mNm	22	22
7	启动电流	Starting current	A	1.1	1.1
8	负载 (刷头)	Rated load (Brush head)	g	3.8	3.8
9	负载振动频次	Load vibration frequency	Times / minute	36000	36000
10	负载电流	Load current	mA	360	400
11	转子惯量	Rotor inertia	gcm <sup>2</sup>	1.8	1.8
12	重量	Weight	g	31	31
13	工作温度范围	Operating temperature range	$^{\circ}\text{C}$	-10~+60	-10~+60

★可选参数 Options: 导线长度 Lead wires length 轴长 Shaft length 性能 Special coils

### 特性曲线 | Characteristics Curve

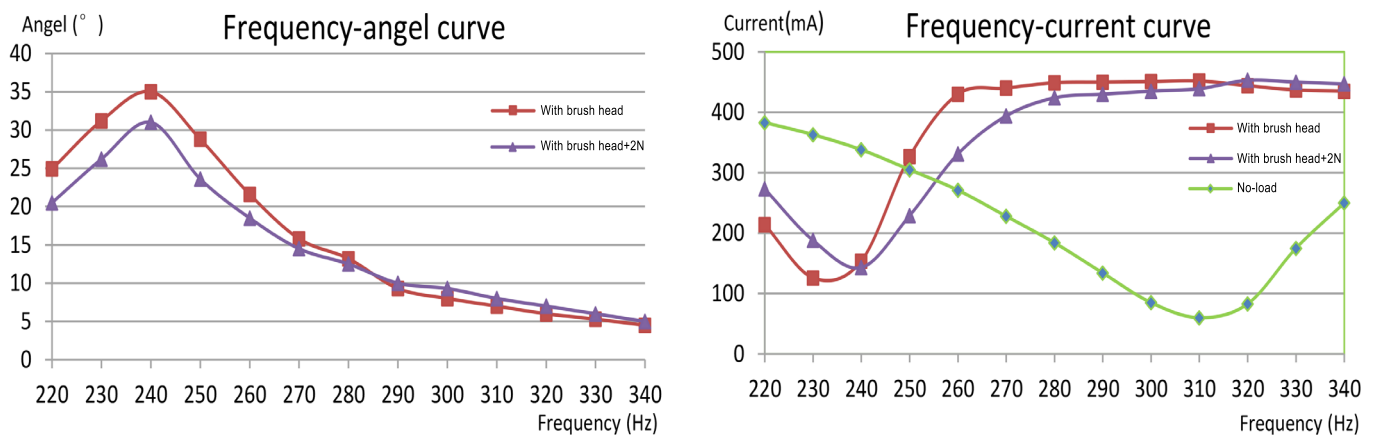

型号 / Model 1941ZDF-1-L3-3.7

### 外观图 | Outline Drawing

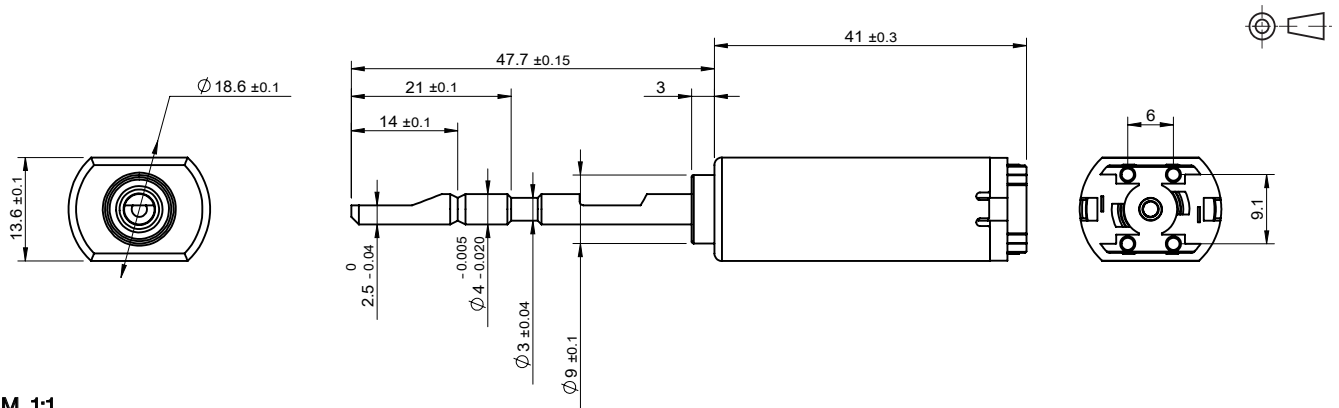

M 1:1